

RVU6421

TOPMOUNT LAUNDRY SINK

RU VATI®
SPECIFICATION SHEET

MATERIAL

True 16 Gauge Thickness
Premium T304 Grade Stainless Steel
18/10 Chromium/Nickel Content
Commercial Brushed Finish

FEATURES

- Heavy duty sound guard padding and undercoating
- Slanted bottom with elegant drain grooves for easy draining
- Single-Tier Ledge for Accessories

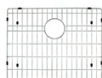

IN THE BOX

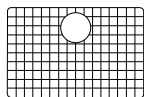

Rinse Grid
[RVA68221]

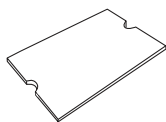

Cutting Board
[RVA1221]



Basket Strainer
[RVA1025]



Mounting Clips
[RVA11042]



Cut-out
Template

NOMINAL DIMENSIONS

Exterior: 21" (wide) x 20" (front-to-back)
Interior Bowl: 19" (wide) x 14-5/8" (front-to-back)
Bowl Depth: 12"
Minimum Cabinet Size: 24" wide
Drain Hole Size: 3-1/2"

Installation Type:
Topmount

Inside Corners:
Zero Radius

Drain Location:
Rear Center

RU VATI USA
www.ruvati.com

Phone: 1.855.478.8284
Email: support@ruvati.com

OPTIONAL ACCESSORIES (SOLD SEPARATELY)

- 

Deep Basket
Disposal Flange
[RVA1049ST]
- 

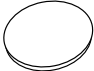
Deep Basket
Disposal Flange/Stopper
[RVA1052ST]
- 

Drain Cover
[RVA1035]
- 

Deep Basket Strainer
and Stopper
[RVA1027ST]

DIMENSIONS

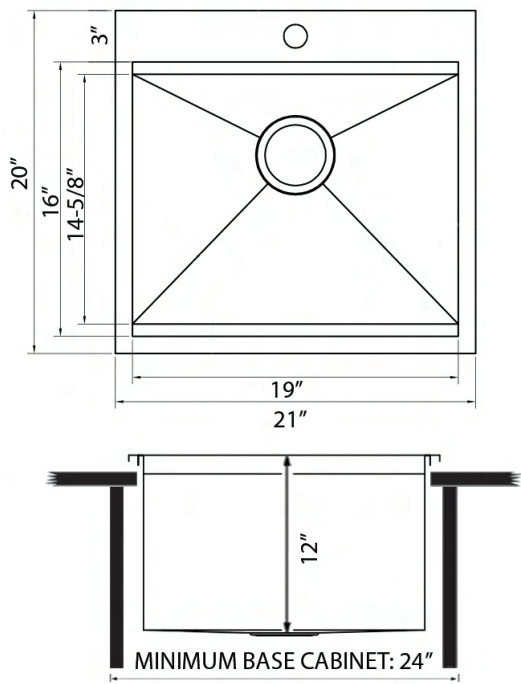



cUPC certified by IAPMO
to meet US and Canada
plumbing standards.



**SCAN TO REGISTER
YOUR WARRANTY**
or visit
ruvati.com/register