

# RVH9301

APRON-FRONT WORKSTATION SINK

**RUVATI**<sup>®</sup>  
SPECIFICATION SHEET

## MATERIAL

True 16 Gauge Thickness  
Premium T304 Grade Stainless Steel  
18/10 Chromium/Nickel Content  
Commercial Brushed Finish

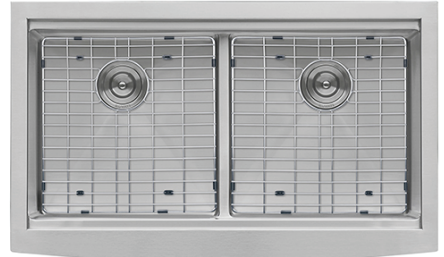

## FEATURES

- Heavy duty sound guard padding and undercoating
- Slanted bottom with elegant drain grooves for easy draining
- Single-Tier Ledge for Accessories

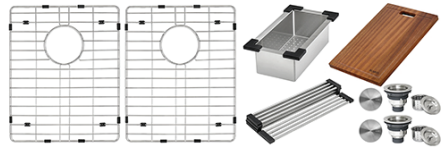

## IN THE BOX

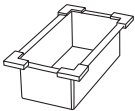

Colander  
[RVA1327]

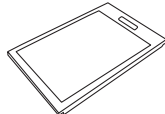

Cutting Board  
[RVA1217]

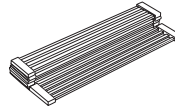

Folding Rack  
[RVA1395]

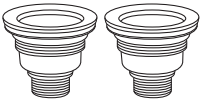

Basket Strainer  
[RVA1025] x 2



Drain Cover  
[RVA1035] x 2

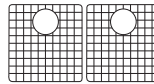

Rinse Grid  
[RVA69301]

## NOMINAL DIMENSIONS

Exterior: 36" (wide) x 22" (front-to-back)  
Interior Bowl: 16" x 16" (left), 16" x 16" (right)  
Bowl Depth: 10" | Front Apron Height: 9"  
Minimum Cabinet Size: 39" wide  
Drain Hole Size: 3-1/2"

Installation Type:  
Apron-Front

Inside Corners:  
Rounded

Drain Location:  
Rear Center

**RUVATI USA**

www.ruvati.com

Phone: 1.855.478.8284  
Email: support@ruvati.com

## OPTIONAL ACCESSORIES (SOLD SEPARATELY)



Deep Basket  
Disposal Flange  
[RVA1049ST]

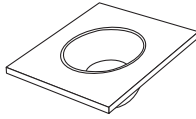

Mixing Bowl  
and Platform  
[RVA1288]

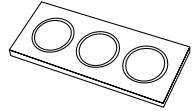

Condiment  
Serving Tray  
[RVA1377]

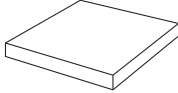

Butcher Block  
[RVA2445ACA]

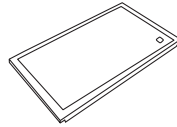

Black Plastic  
Cutting Board  
[RVA1217BLK]

## DIMENSIONS

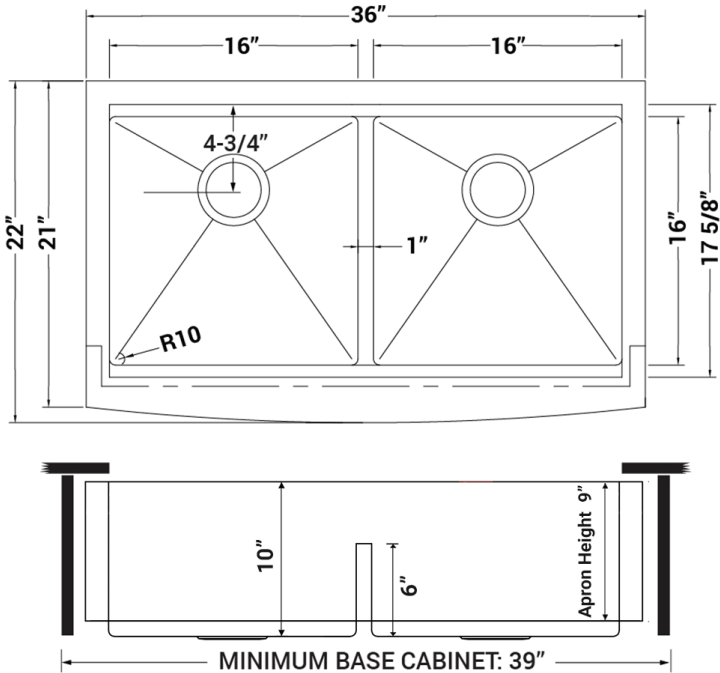

Register your product at [www.ruvati.com/register](http://www.ruvati.com/register).