

RVG11080BK

GRANITE TOPMOUNT WORKREADY™ SINK

RUVATI[®]
SPECIFICATION SHEET

MATERIAL

- Solid Granite Composite
- 80% crushed natural granite for extreme strength
- Non-porous and resistant to stains

FEATURES

- Built-in ledges support workstation accessories
- Will never discolor
- Rounded inside corners
- Naturally sound proof



IN THE BOX



Basket Strainer
[RVA1038BL]

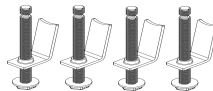

Mounting Clips
[RVA11055]



Cut-out
Template

NOMINAL DIMENSIONS

Exterior: 33" (wide) x 22" (front-to-back)
Interior Bowl: 30-1/4" (wide) x 16-3/4" (front-to-back)
Bowl Depth: 10"
Minimum Cabinet Size: 36" wide
Drain Hole Size: 3 1/2"

Installation Type:
Topmount
Inside Corners:
Rounded
Drain Location:
Rear Center

RUVATI USA
www.ruvati.com

Phone: 1.855.478.8284
Email: support@ruvati.com

OPTIONAL ACCESSORIES (SOLD SEPARATELY)

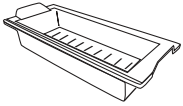

Colander
[RVA1367BLK]

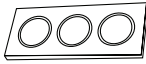

Condiment
Serving Tray
[RVA1377BWC]

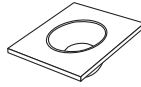

Mixing Bowl
and Platform
[RVA1288BWC]



Caddy
[RVA1580]

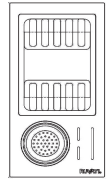

Drying Rack
[RVA1542BWC]

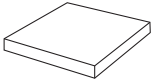

Butcher Block
[RVA2445ACA]



Garbage
Disposal Flange
[RVA1041BL/GG]

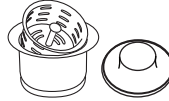

Deep Basket
Disposal Flange/Stopper
[RVA1052BL/GG]



Deep Basket Strainer
and Stopper
[RVA1027BL/GG]

DIMENSIONS

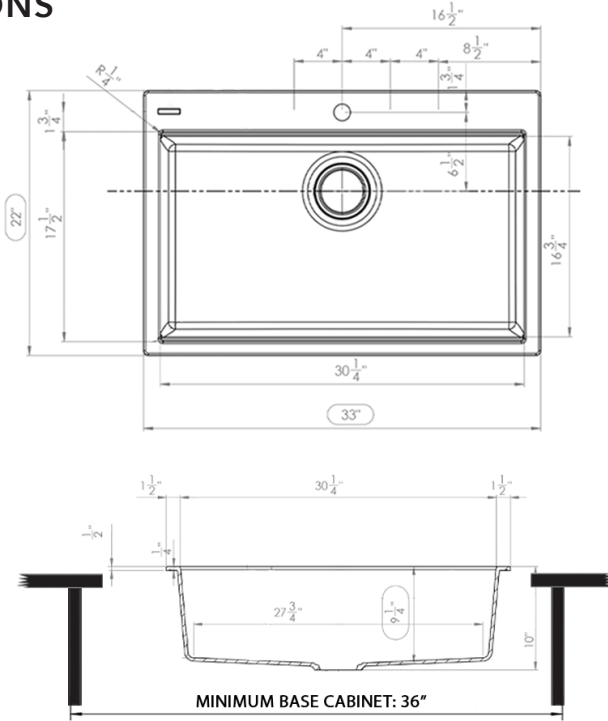

cUPC certified by IAPMO
to meet US and Canada
plumbing standards.



SCAN TO REGISTER
YOUR WARRANTY

or visit
ruvati.com/register

RUVATI USA
www.ruvati.com

Phone: 1.855.478.8284
Email: support@ruvati.com