

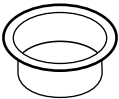





ATTENTION INSTALLER

- Read all instructions carefully before installation. Inspect the item and make sure you have all the parts shown in the parts list below.
- If any part is missing or damaged, please contact Ruvati Support at 1-855-478-8284 or www.ruvati.com.

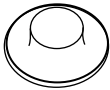
INCLUDED	NOT INCLUDED (comes with your garbage disposal unit)
Flange → 	 ← Black Rubber Splash Guard
Stopper → 	 ← Triangle Ring
	 ← Mounting Ring
	 ← Screws
	 ← Snap Ring



INSTALLATION GUIDE

GARBAGE DISPOSAL FLANGE
AND STOPPER

RVA1041



Address: 2705 Meister Pl, Round Rock, TX 78664
USA Phone: 1.855.478.8284
Email: info@ruvati.com

1. Apply a rope of plumbers putty around the underside of the sink flange. Insert the Flange into the drain opening of the sink.

2. Place the Triangle Support Ring (not included), and the Mounting Ring (not included) from below the sink.

3. Attach the Snap Ring (not included) on to the flange. It should snap into the lower groove near the bottom of the flange.

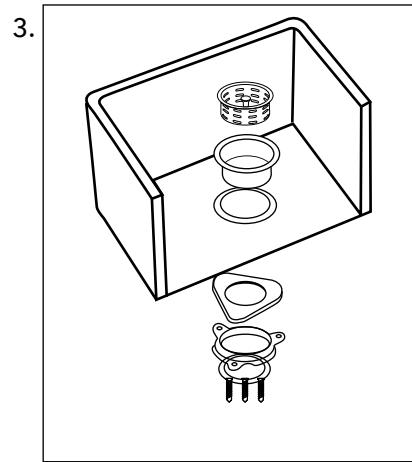

4. Screw in the 3 screws (not included) into the Mounting Ring. Fully tighten all 3 screws. The flange is now secured to the sink.

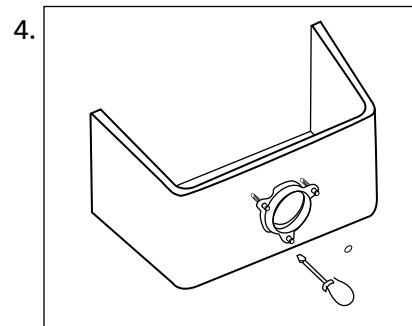

5. Install the Black Rubber Splash Guard (not included) onto the opening of the disposal unit, then securely attach the disposal to the mounting ring following the manufacturer's instructions. Your disposal is now ready for use.

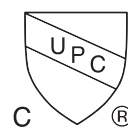
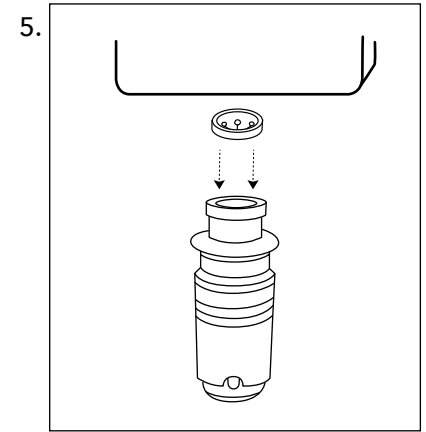

cUPC certified by IAPMO
to meet US and Canada
plumbing standards.



**SCAN TO REGISTER
YOUR WARRANTY**

or visit
ruvati.com/register